

MISCELLANEOUS INFORMATION

PERIMETER:-	112'
SURFACE AREA:	761.5 SQ FT
VOLUME:	22653 IMP GALS 103072 L

CONCRETE DECK INFO

WIDTH	AREA	NET INCREASES FOR:			
		STEPS	DIVING	SLIDE	ROLLER
2'	237	13	27	24	10
2'6"	300	17	31	20	10
3'	364	20	36	16	10

All Figures Represent "Sq Ft"

PARTS LIST

CODE	QTY	DESCRIPTION
8R10-i	1	8' Return x 10' Rad
8R10	3	8' Plain x 10' Rad
36R10	1	3'6 Plain x 10' Rad
7R10R	1	7' Plain x 10 Reverse Rad
8R9-s	1	8' Skimmer x 9' Rad
8R9	1	8' Plain x 9' Rad
56R9	1	5'6 Plain x 9' Rad
5R8	1	8' Plain x 8' Rad
8R8-i	1	8' Return x 8' Rad
8R8	2	8' Plain x 8' Rad
8R7R	2	8' Plain x 7' Reverse Rad
3R7R	1	3' Plain x 7' Reverse Rad
AF	16	A-Frame
S	32	Stake
NB	96	Nuts & Bolts

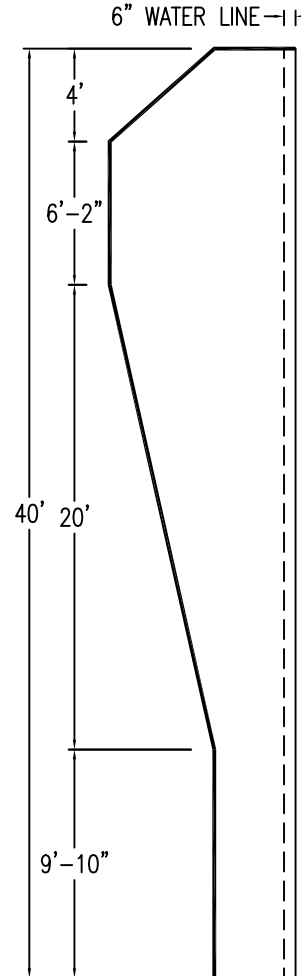
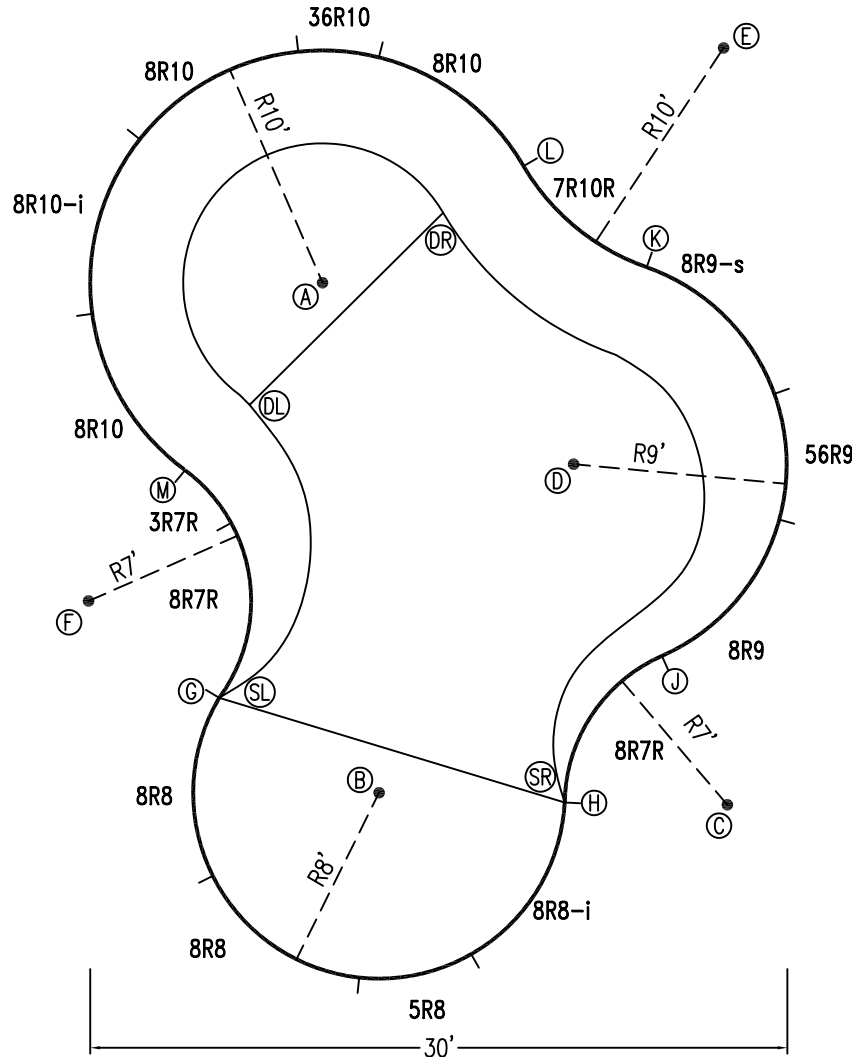

INSTALLATION DATA

From Point "A" to:-		From Point "B" to:-	
B	22'-0 7/8"	B	15'-0"
C	28'-5 1/8"	C	15'-0"
D	13'-3 7/8"	D	16'-5 1/8"
E	20'-0"	E	35'-3 3/4"
F	17'-0"	F	14'-11 3/4"
G	18'-4 7/8"	G	8'-0"
H	24'-8 1/8"	H	8'-0"
J	21'-8 1/2"	J	13'-6 1/4"
K	13'-11 5/8"	K	25'-4 1/2"
L	10'-0"	L	27'-8 1/8"
M	10'-0"	M	16'-2 3/4"
SR	24'-8 1/8"	SR	8'-0"
SL	18'-4 7/8"	SL	8'-0"
DR	6'-0"	DR	25'-1 3/8"
DL	6'-1 1/2"	DL	17'-7 1/8"

NOTICE

SWIMMING POOLS AND ACCESSORIES (INCLUDING DIVING BOARDS) ARE DANGEROUS WHEN IMPROPERLY USED OR INSTALLED. IT IS THE RESPONSIBILITY OF MUNICIPAL OFFICIALS, BUILDERS AND POOL OWNERS TO ADHERE TO ALL SAFETY RECOMMENDATIONS AND STANDARDS ISSUED BY THE POOL & HOT TUB COUNCIL, LOCAL AUTHORITIES AND EQUIPMENT MANUFACTURERS. PLEASE REFER TO DIVING BOARD MANUFACTURERS FOR CORRECT POSITIONING AND INSTALLATION OF DIVING EQUIPMENT.

\*ALL DIMENSIONS ARE FINISHED



AQUAPRO

MUSKOKA - LEFT 30 x 40

DRAWING REFERENCE #  
26-30-40-1

DRAWN BY: BC  
REV. 7 MAR 08  
SHEET 1 OF 2

EXTERNAL INSTALLATION DATA

AA TO:	BB TO:	CC TO:	DD TO:
AA ---	AA 40'-0"	AA 29'-11 5/8"	AA 49'-11 3/4"
BB ---	BB ---	BB 49'-11 3/4"	BB 29'-11 5/8"
CC ---	CC ---	CC ---	CC 40'-0"
A 22'-3 7/8"	A 36'-0 5/8"	A 14'-1 5/8"	A 31'-7 5/8"
B 36'-5 1/4"	B 19'-3 5/8"	B 34'-3 1/4"	B 14'-9 7/8"
C 32'-6 3/4"	C 7'-11 1/2"	C 42'-5 7/8"	C 28'-5 1/4"
D 20'-0 1/4"	D 24'-0 1/4"	D 27'-4 1/2"	D 30'-5 1/8"
E 2'-8 5/8"	E 40'-2 1/2"	E 27'-3 1/8"	E 48'-5 7/8"
F 38'-3 1/8"	F 34'-2 1/4"	F 23'-8 1/4"	F 16'-3 3/4"
G 37'-0 1/2"	G 27'-3 1/4"	G 28'-4 3/4"	G 13'-4 1/4"
H 33'-8 7/8"	H 12'-2 3/4"	H 38'-3 1/8"	H 21'-9 5/8"
J 26'-7 1/8"	J 14'-11 3/8"	J 35'-9 7/8"	J 28'-3 3/8"
K 11'-1 1/8"	K 31'-3 1/8"	K 25'-8 3/8"	K 38'-11"
L 12'-4 3/8"	L 36'-9 7/8"	L 19'-3 3/8"	L 39'-8 3/8"
M 31'-6 7/8"	M 33'-11 5/8"	M 18'-5 3/4"	M 22'-4"
SR 33'-8 7/8"	SR 12'-2 3/4"	SR 38'-3 1/8"	SR 21'-9 5/8"
SL 37'-0 1/2"	SL 27'-3 1/4"	SL 28'-4 3/4"	SL 13'-4 1/4"
DR 16'-4 1/8"	DR 36'-2 1/8"	DR 16'-8 5/8"	DR 36'-4 1/8"
DL 27'-8 1/4"	DL 33'-10 3/8"	DL 16'-8 5/8"	DL 25'-8 1/4"

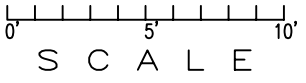
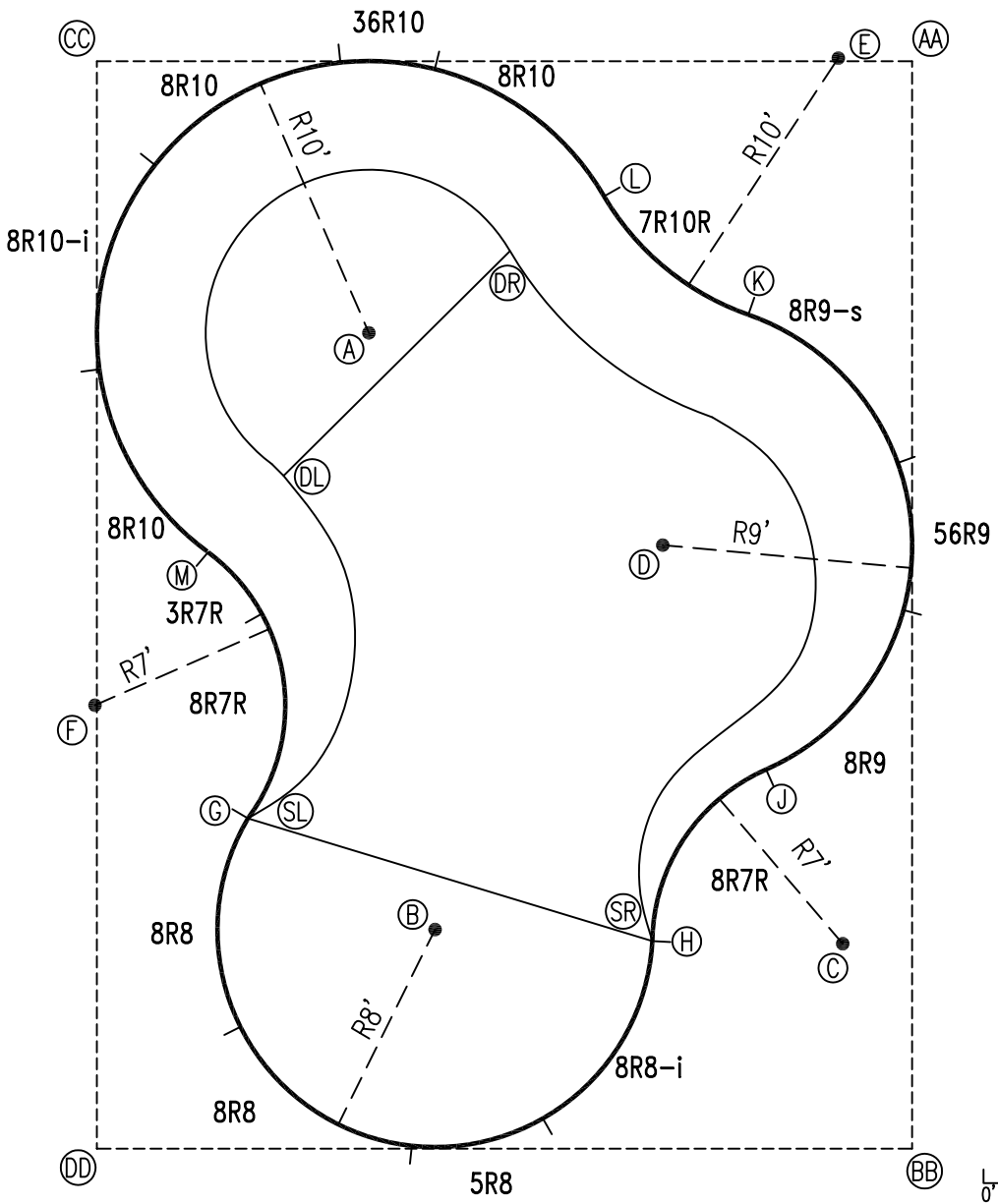

NOTICE

SWIMMING POOLS AND ACCESSORIES (INCLUDING DIVING BOARDS) ARE DANGEROUS WHEN IMPROPERLY USED OR INSTALLED. IT IS THE RESPONSIBILITY OF MUNICIPAL OFFICIALS, BUILDERS AND POOL OWNERS TO ADHERE TO ALL SAFETY RECOMMENDATIONS AND STANDARDS ISSUED BY THE POOL & HOT TUB COUNCIL, LOCAL AUTHORITIES AND EQUIPMENT MANUFACTURERS. PLEASE REFER TO DIVING BOARD MANUFACTURERS FOR CORRECT POSITIONING AND INSTALLATION OF DIVING EQUIPMENT.

AQUAPRO

MUSKOKA - LEFT 30 x 40

DRAWING REFERENCE #  
26-30-40-1

DRAWN BY: BC  
REV. 7 MAR 08  
SHEET 2 OF 2