

### MISCELLANEOUS INFORMATION

PERIMETER:-		105'-2			
SURFACE AREA:		728 SQ FT			
VOLUME:		20,271 IMP GALS 94,284 L			
<b>CONCRETE DECK INFO</b>					
WIDTH	AREA	NET INCREASES FOR:-			
		STEPS	DIVING	SLIDE	ROLLER
2'	223	13	27	24	10
2'6"	283	17	31	20	10
3'	343	20	36	16	10
All Figures Represent "SQ Ft"					

### PARTS LIST

CODE	QTY	DESCRIPTION
8R10-s	1	8' Skim x 10' Rad
8R10-i	1	8' Return x 10' Rad
4R10	1	4' Plain x 10' Rad
8R10	2	8' Plain x 10' Rad
6R10R	1	6' Plain x 10' Reverse Rad
8R86-i	1	8' Return x 8'6" Rad
8R86	2	8' Plain x 8'6" Rad
2R86	1	2' Plain x 8'6" Rad
8R8	1	8' Plain x 8' Rad
2R8	1	2' Plain x 8' Rad
8R7	1	8' Plain x 7' Rad
5R7	1	5' Plain x 7' Rad
7R6R	1	7' Plain x 6' Reverse Rad
4R4R	1	4' Plain x 4' Reverse Rad
32R4R	1	3'2" Plain x 4' Rev Rad
AF	17	A-Frame
S	34	Stake
NB	102	Nuts & Bolts

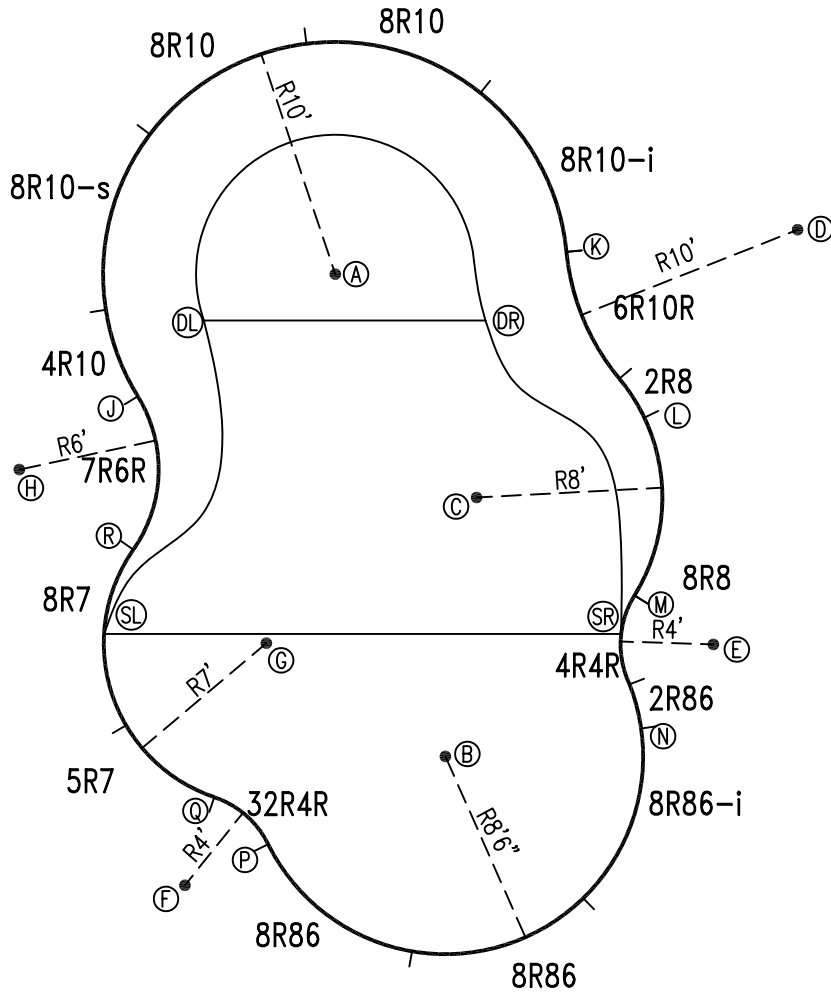

6" WATER LINE - I-I-

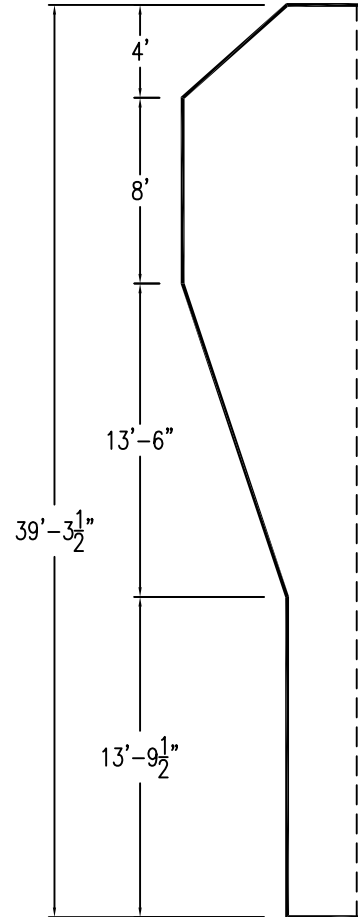

\*ALL DIMENSIONS ARE FINISHED

### INSTALLATION DATA

From Point "A" to:-		From Point "B" to:-	
B	21'-3 5/8"	B	
C	11'-4 5/8"	C	11'-2 3/4"
D	20'-0"	D	27'-3 3/8"
E	22'-9 1/2"	E	12'-6 1/8"
F	27'-1 1/4"	F	12'-6 1/4"
G	16'-2"	G	9'-1 1/2"
H	16'-0"	H	22'-1 3/8"
J	10'-0"	J	20'-4 3/4"
K	10'-0"	K	22'-4 1/8"
L	14'-8 1/8"	L	16'-11"
M	18'-10 7/8"	M	10'-8 3/8"
N	23'-7"	N	8'-6 1/4"
P	24'-8 5/8"	P	8'-6 1/4"
Q	23'-1 3/8"	Q	10'-1 1/4"
R	14'-8 5/8"	R	16'-1 1/2"
SL	18'-5"	SL	15'-7 3/8"
SR	19'-9 1/2"	SR	9'-2 3/4"
DL	6'-0"	DL	21'-5 1/2"
DR	6'-9 1/4"	DR	18'-10 1/4"

### NOTICE

SWIMMING POOLS AND ACCESSORIES (INCLUDING DIVING BOARDS) ARE DANGEROUS WHEN IMPROPERLY USED OR INSTALLED. IT IS THE RESPONSIBILITY OF MUNICIPAL OFFICIALS, BUILDERS AND POOL OWNERS TO ADHERE TO ALL SAFETY RECOMMENDATIONS AND STANDARDS ISSUED BY THE POOL & HOT TUB COUNCIL, LOCAL AUTHORITIES AND EQUIPMENT MANUFACTURERS. PLEASE REFER TO DIVING BOARD MANUFACTURERS FOR CORRECT POSITIONING AND INSTALLATION OF DIVING EQUIPMENT.

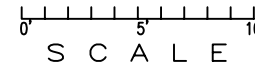

AQUAPRO

CARIBBEAN - LEFT 24 x 40

DRAWING REFERENCE #  
5A-24-40-1

DRAWN BY: BC  
REV. 15 JAN 2007  
SHEET 1 OF 2

EXTERNAL INSTALLATION DATA

AA TO:	BB TO:	CC TO:	DD TO:
AA	AA 39'-2 1/2"	AA 24'-0 1/8"	AA 45'-11 3/4"
BB	BB	BB 45'-11 3/4"	BB 24'-0 1/8"
CC	CC	CC	CC 39'-2 1/2"
A	A 30'-11"	A 17'-2 3/4"	A 32'-5 7/8"
B	B 16'-11 1/2"	B 32'-1"	B 12'-7 5/8"
C	C 25'-4 3/8"	C 21'-1 3/8"	C 21'-2 3/4"
D	D 43'-2"	D 9'-10 7/8"	D 31'-8 3/4"
E	E 29'-4 7/8"	E 25'-11 5/8"	E 13'-6 1/8"
F	F 4'-6 5/8"	F 41'-8"	F 20'-9 1/4"
G	G 15'-1 1/8"	G 30'-11 1/4"	G 21'-8 1/8"
H	H 21'-2 1/4"	H 33'-2 1/2"	H 34'-8"
J	J 24'-0 3/4"	J 27'-2 5/8"	J 32'-11 5/8"
K	K 36'-2 1/4"	K 9'-10 1/2"	K 30'-6 1/4"
L	L 32'-9 1/4"	L 16'-1 1/2"	L 23'-1 3/8"
M	M 27'-6 5/8"	M 23'-9 1/2"	M 15'-5 7/8"
N	N 25'-0 3/4"	N 29'-6 1/8"	N 9'-9 1/8"
P	P 8'-5 3/4"	P 38'-5 1/2"	P 17'-7"
Q	Q 8'-2 7/8"	Q 37'-9"	Q 20'-5 3/8"
R	R 17'-5 1/2"	R 31'-6 1/4"	R 28'-8 1/8"
SL	SL 13'-9 1/2"	SL 34'-11 5/8"	SL 27'-8 1/4"
SR	SR 26'-2"	SR 25'-5 3/4"	SR 13'-10 3/4"
DL	DL 27'-7 3/8"	DL 23'-0 3/4"	DL 33'-8 1/8"
DR	DR 31'-9 7/8"	DR 14'-1 3/4"	DR 28'-3 7/8"

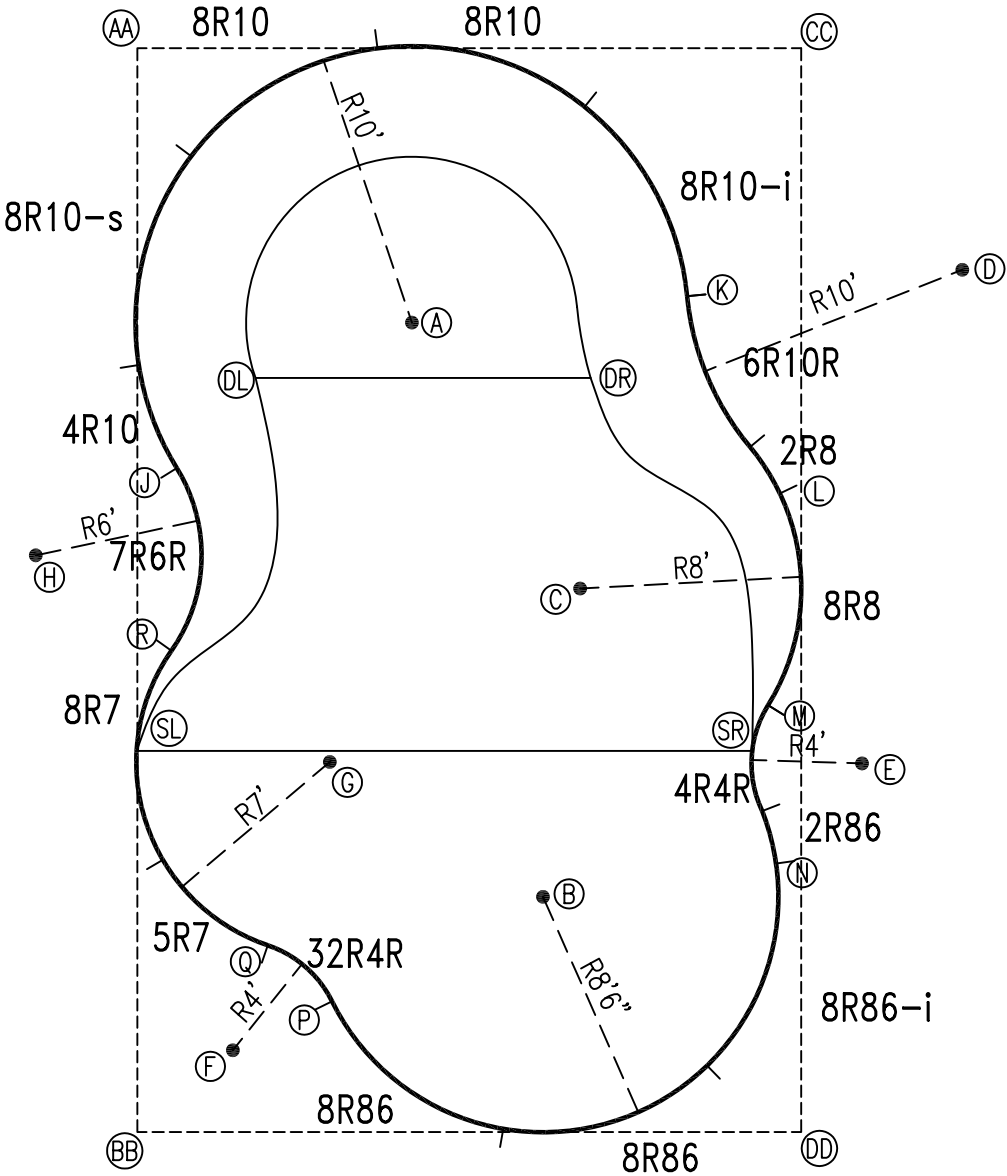

NOTICE

SWIMMING POOLS AND ACCESSORIES (INCLUDING DIVING BOARDS) ARE DANGEROUS WHEN IMPROPERLY USED OR INSTALLED. IT IS THE RESPONSIBILITY OF MUNICIPAL OFFICIALS, BUILDERS AND POOL OWNERS TO ADHERE TO ALL SAFETY RECOMMENDATIONS AND STANDARDS ISSUED BY THE POOL & HOT TUB COUNCIL, LOCAL AUTHORITIES AND EQUIPMENT MANUFACTURERS. PLEASE REFER TO DIVING BOARD MANUFACTURERS FOR CORRECT POSITIONING AND INSTALLATION OF DIVING EQUIPMENT.

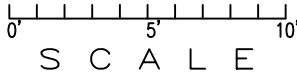

AQUAPRO

CARIBBEAN - LEFT 24 x 40

DRAWING REFERENCE #  
5A-24-40-1

DRAWN BY: BC  
REV. 15 JAN 2007  
SHEET 2 OF 2